

## FABRIC POUCH NECKLACE

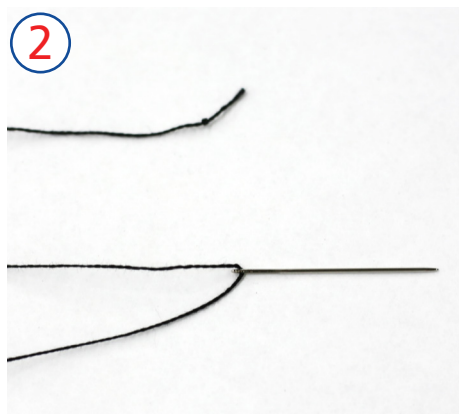

1 Pick out three colors of felt. You will need one color for the pouch and two colors for the design.



2 Cut an arms length of thread and knot the end. Thread the other end through your needle.

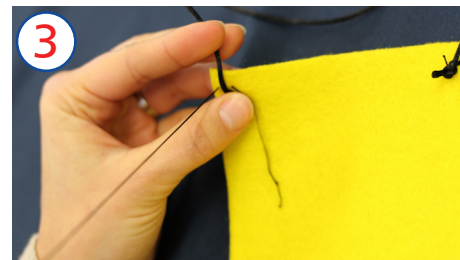

3 Sew both ends of the cord to the back of the pouch by going around the cord multiple times near the knot. The ends should be sewn to the top of one felt rectangle like in the picture. The knots will help hold it in place. This will be the back of your pouch.



4 Align the back of your pouch with the piece of felt that will be the front. Sew around the three edges of two pieces of felt using a straight stitch. (Going from front, to back, to front, with your needle.)



5 When finished, tie a knot, trim your thread, and insert the sheet of cardstock inside the top of the pouch.



6 Taking your two colors of felt, cut and create a design to be glued on your felt pouch. Try to use every piece of fabric, without waste.



7 Once you have your design cut and laid out, use a small amount of glue to adhere it to the pouch. Don't use too much glue or it will leak through the fabric.

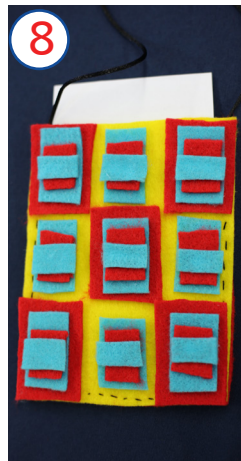

8 Let the glue dry. (1 hour to touch, 24 hours to wear.)

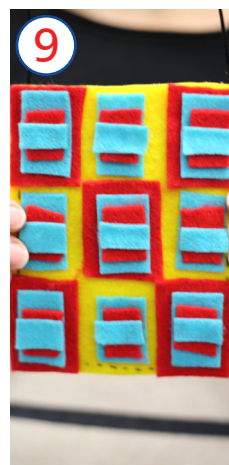

9 Voila! You have a fabric pouch necklace!